



16800
 Nylon Screw, Spacer,
 Washer & Brass Nut

M6-1.0 x 20mm
**Slotted Pan Head License
 Plate Screw & Hardware**
 Head Diameter: 12mm (15/32")
 Hex Width (ATF): 10mm (25/64")
 Washer O.D.: 12.5mm (1/2")
 Spacer O.D.: 19mm (3/4")
 Toyota

UNIT PACKAGE: 25 Sets



17636
 Nylon

License Plate Bracket Spacer
 I.D.: 1/4" (6mm)
 O.D.: 3/4" (19mm)
 Thickness: 1/4" (6mm)
 Toyota

UNIT PACKAGE: 50



2625
 Nylon

License Plate Nut & Headlight Door Screw
 Screw Size: #8
 Mounting Screw Nut
 Chrysler

UNIT PACKAGE: 100



23587
 1747001
 White Nylon

License Plate Nut
 Screw Size: M3.5 (#6)
 Head Size: 9.5mm
 Fits into 7mm Sq. Hole
 American Motors

UNIT PACKAGE: 100



5228
 (3783006)
 Nylon

License Plate Nut
 Screw Size: #10
 Use with Screw 5278 GM

UNIT PACKAGE: 50



13466
 (6032516)
 Black Nylon

License Plate Nut
 Screw Size: #12
 Chrysler

UNIT PACKAGE: 25

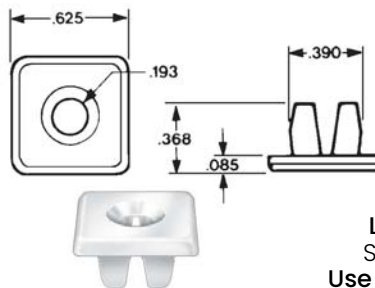

3682
 (1196781)
 Nylon

License Plate Nut
 Screw Size: 1/4"-20
 Use with Screw 5307 GM

UNIT PACKAGE: 50

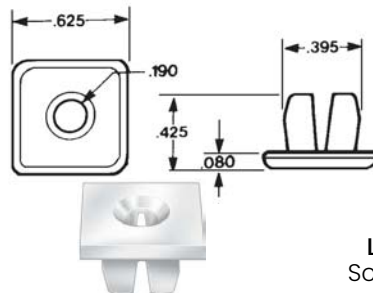

8435
 (4755299)
 Nylon

License Plate Nut
 Screw Size: 1/4" (#14)
 GM

UNIT PACKAGE: 50

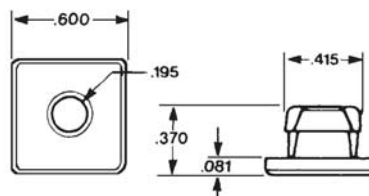

11719
 (3907444)
 Nylon

License Plate Nut
 Screw Size: 1/4" (#14)
 GM

UNIT PACKAGE: 50